

Four new, low cost end supports work great and are drop-in replacements for many competitor installations

Features and Benefits

Thomson has expanded its offering of ball screw end support units to include four new, low cost models: BK / BF and FK / FF. The existing Thomson Quick Mount (QK) and Floating Mount (QF) end supports are still available.

- The BK end supports are fixed base mounted rectangular units. The BF end supports are floating base mounted rectangular units.
- The FK end supports are fixed flange mount round units. The FF end supports are floating mounted round units.

- These new low cost end supports from Thomson are drop-in replacements for selected competitive products from THK, NSK, Misumi and Kuroda.
- 30 new support units have been added for metric $\frac{1}{4}$ inch (50mm).
- Fixed and floating simple supports are stocked for fast delivery.



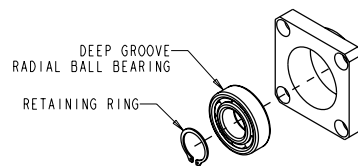
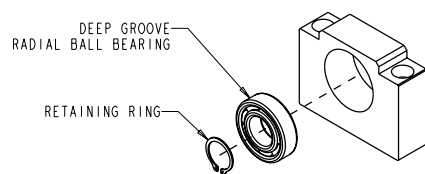
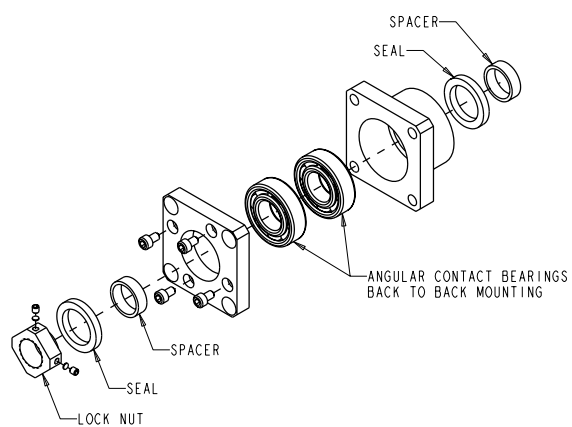
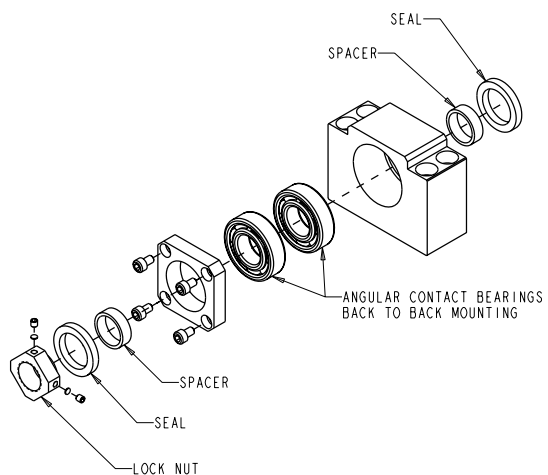

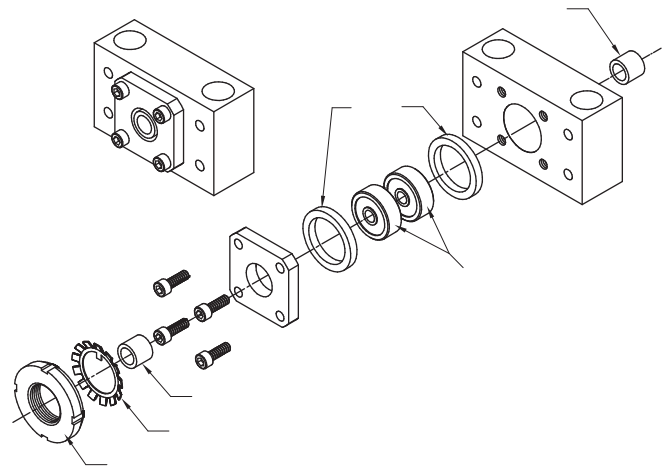
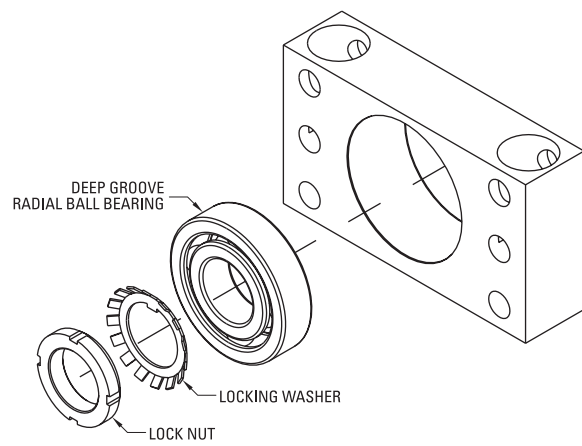

[illegible][illegible][illegible]

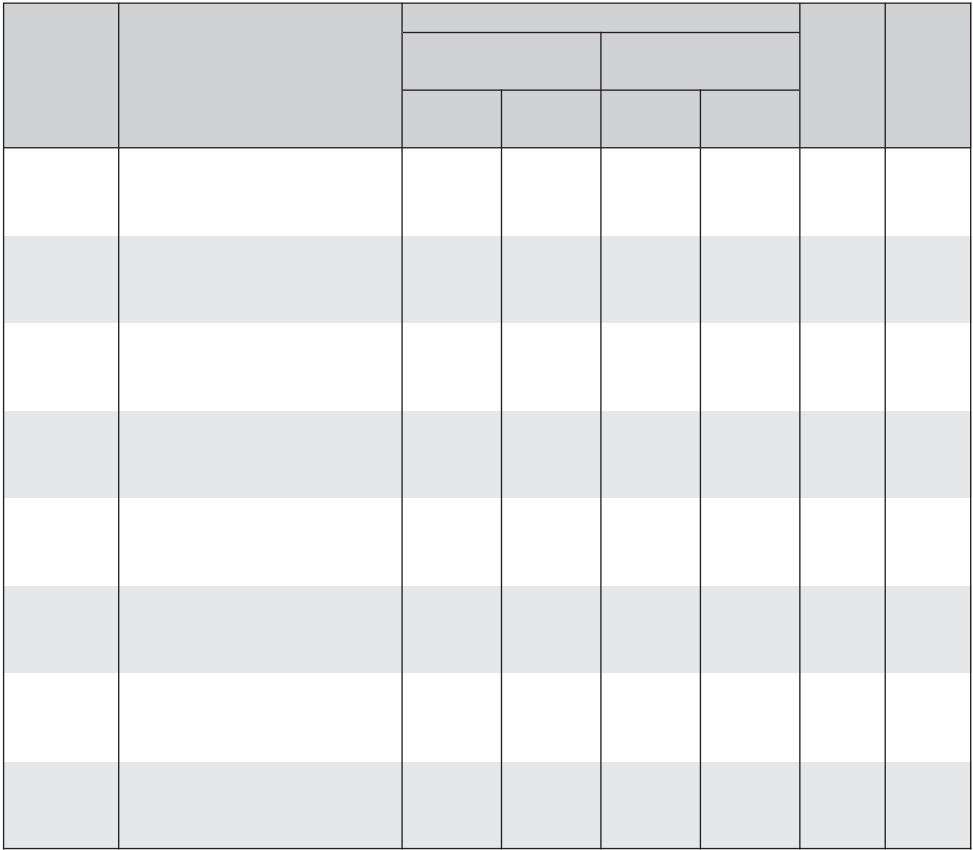
[illegible]

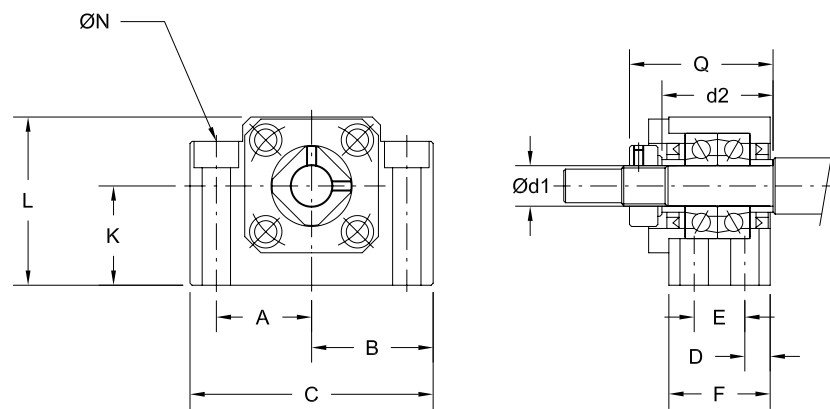
[illegible]

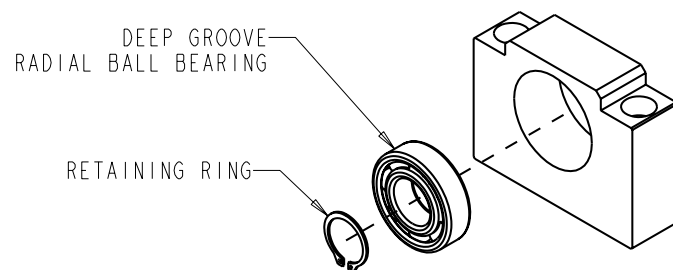
[illegible]

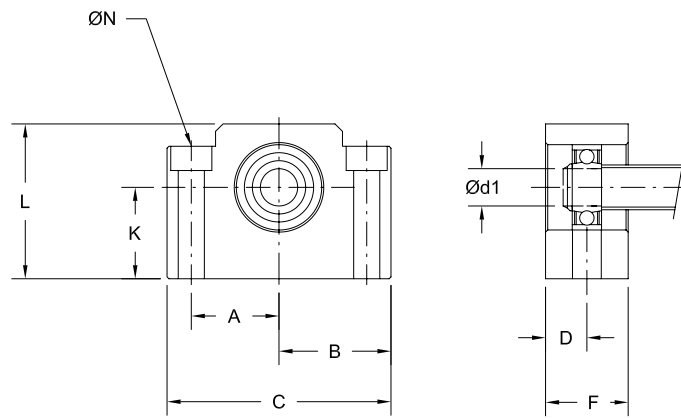

7833368								
7833369								
7833370								
7833371								
7833372								
7833373								
7833374								
7833375								

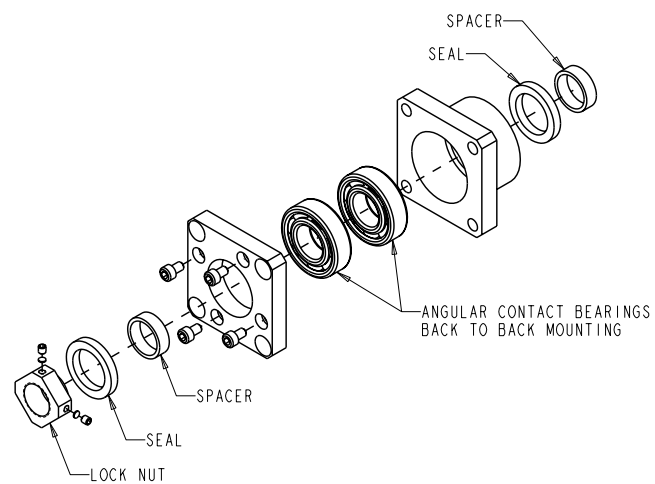
[illegible]

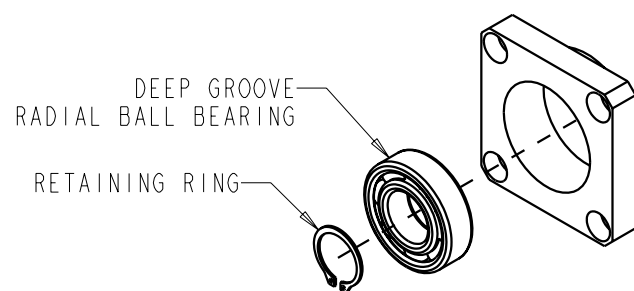
[illegible]

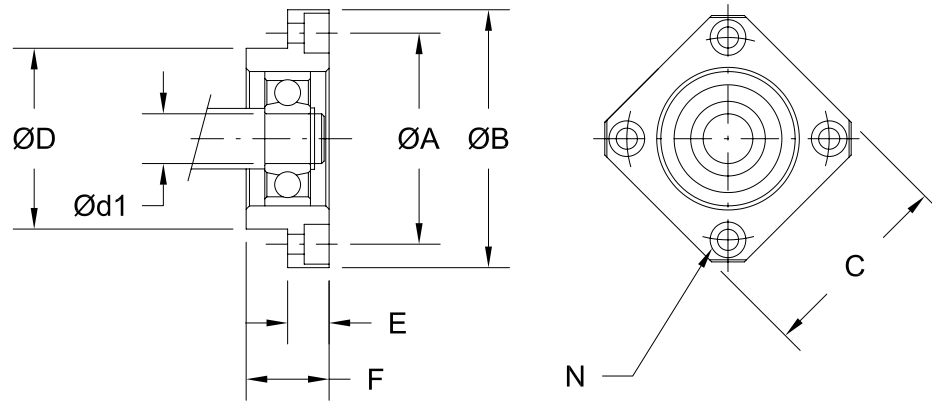

7833384								
7833385								
7833386								
7833387								
7833388								
7833389								
7833390								

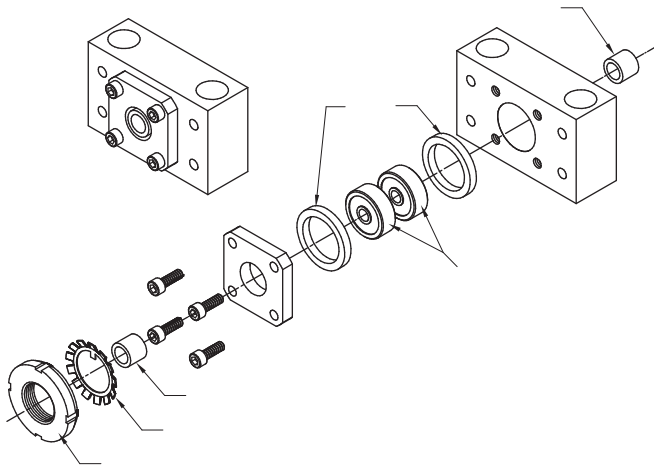

7828282 ⁽¹⁾							
7824154							
7824155							
7824156							
7824157							
7824158							
7824159							
7829554							
7824160							
7824161							

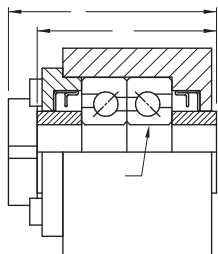
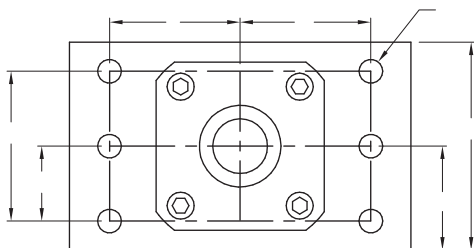
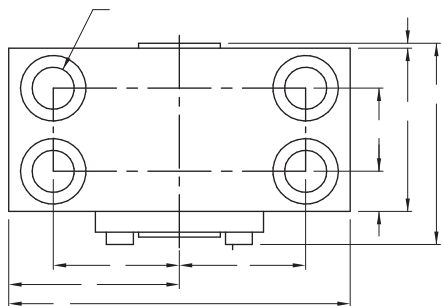

7828282																
7824154																
7824155																
7824156																
7824157																
7824158																
7824159																
7829554																
7824160																
7824161																



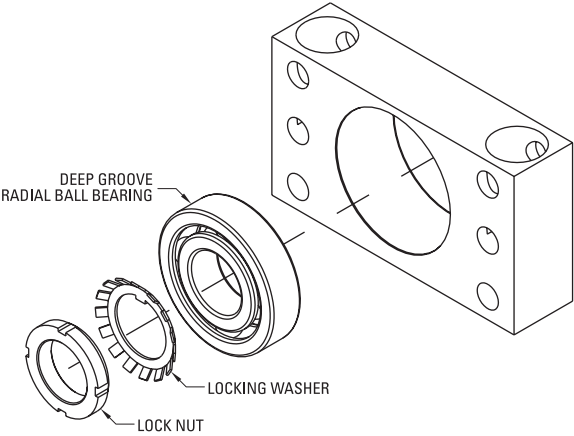

7833291							
7833256							
7833259							
7833262							
7833265							
7833268							
7833270							
7833273							
7833276							
7833279							

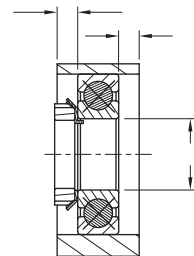
[illegible]

Technical drawing of a shaft with a THD (Threaded Hole Diameter) and dimensions A, B, E, and ØC.

Technical drawing of a shaft with a thread (THD) and dimensions $\varnothing C$, $\varnothing D$, E , and B .

	7833384										7833377							
	7833385										7833378							
	7833386										7833379							
	7833387										7833380							
	7833388										7833381							
	7833389										7833382							
	7833390										7833383							

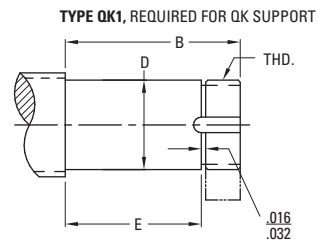
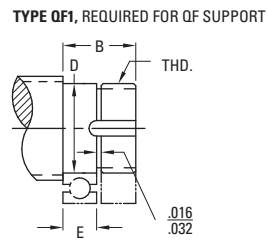
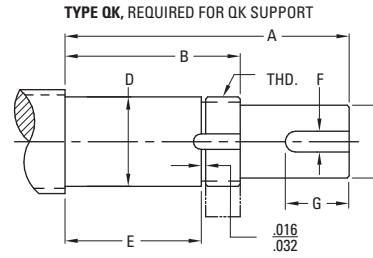
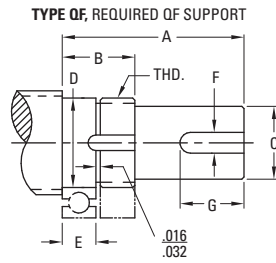
[illegible]

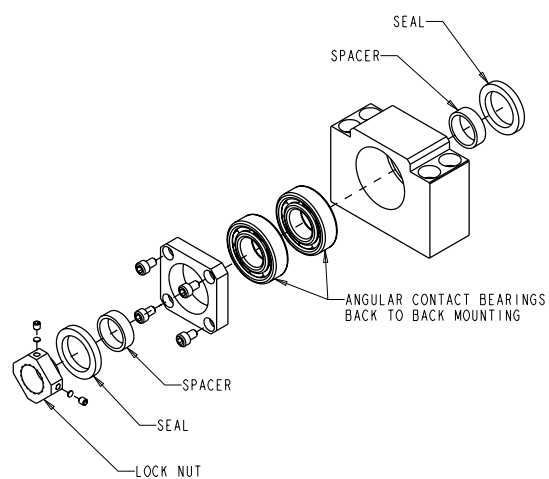

[illegible]

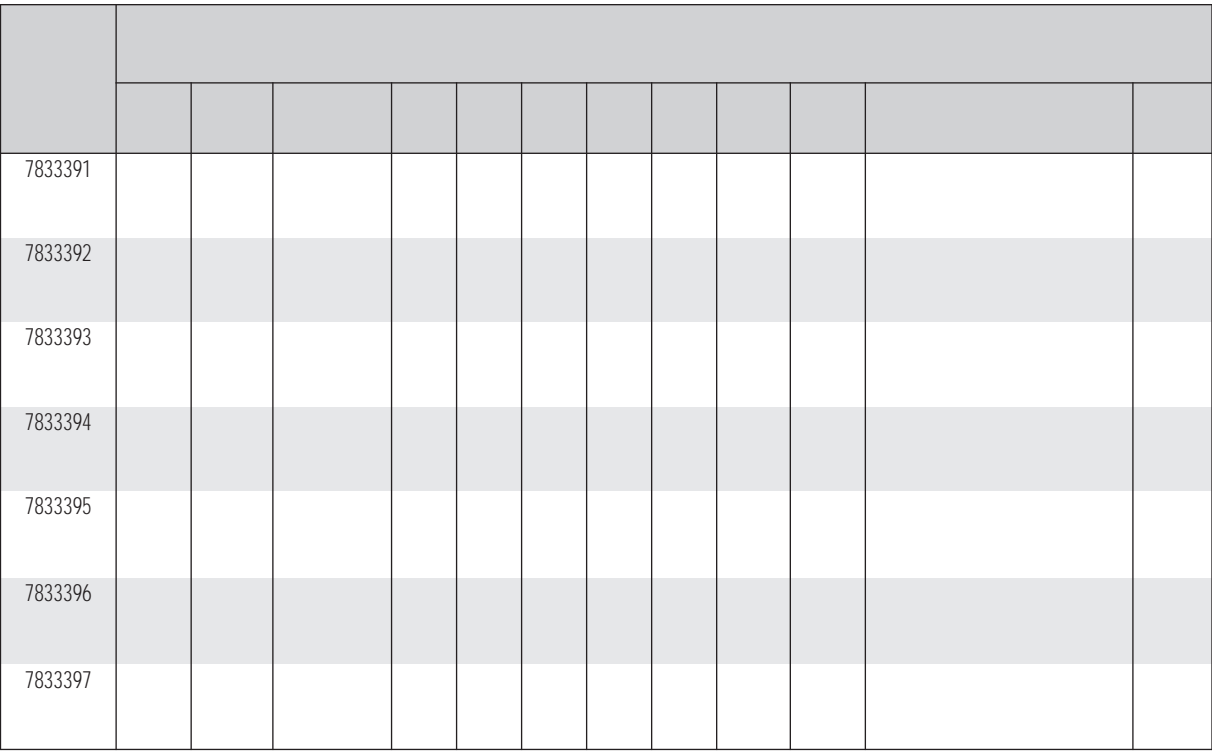

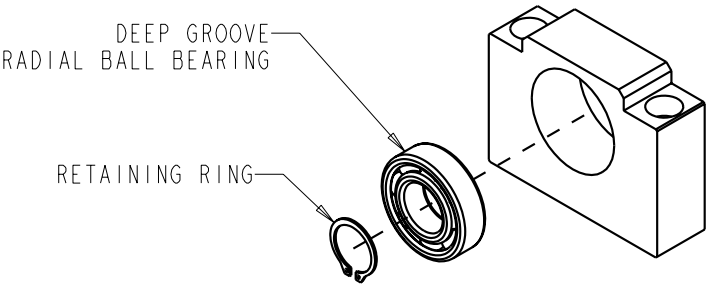

7833400							
7833401							
7833402							
7833403							
7833404							

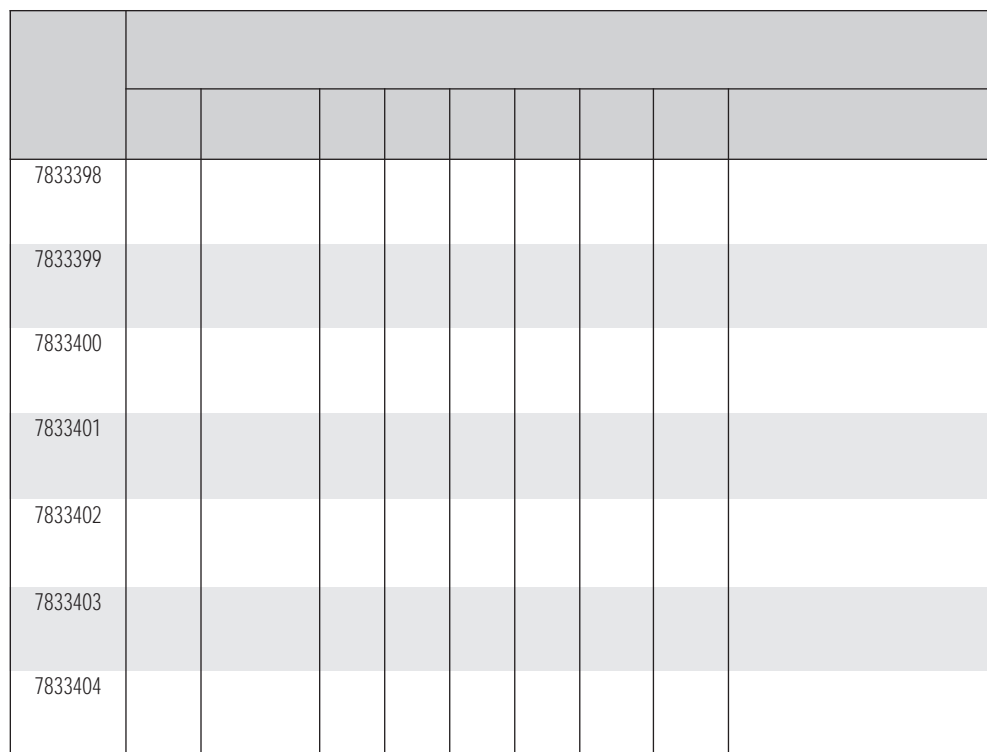

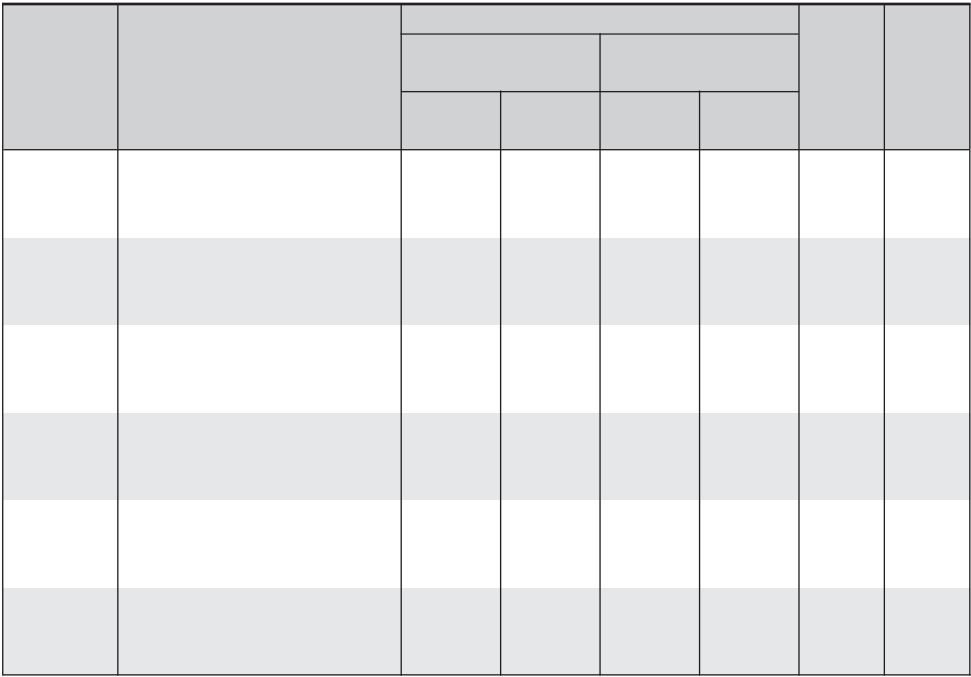

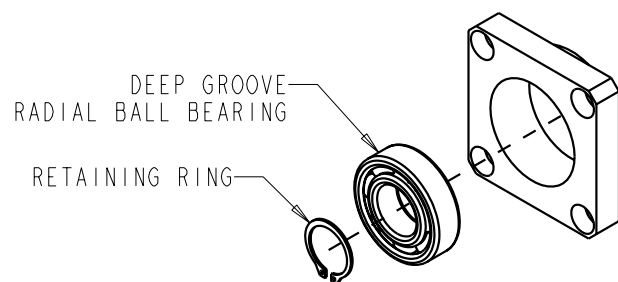
[illegible]

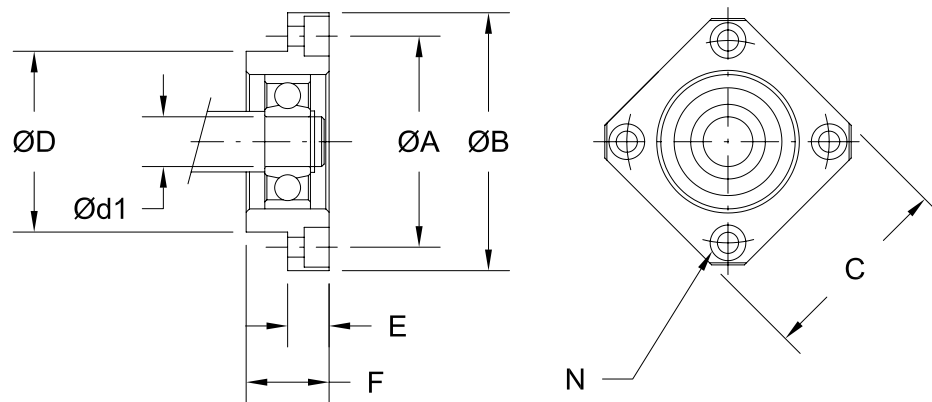

7833411								
7833412								
7833413								
7833414								
7833415								
7833416								

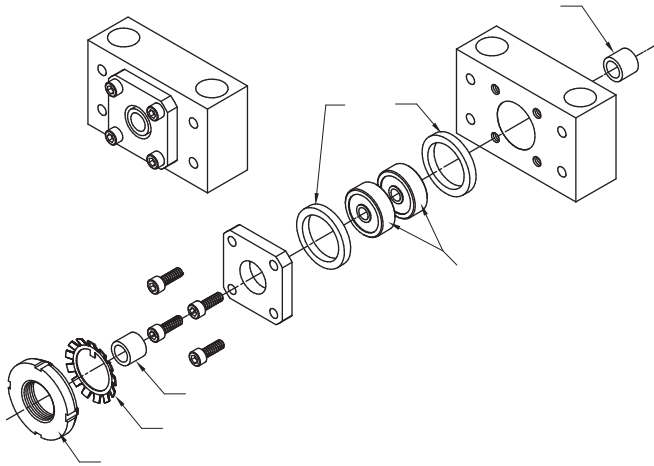

7829546 ⁽¹⁾							
7829547							
7829548							
7829549							
7829550							
7829551							
7829552							
7829553							

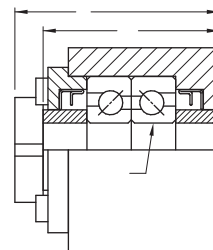
[illegible]

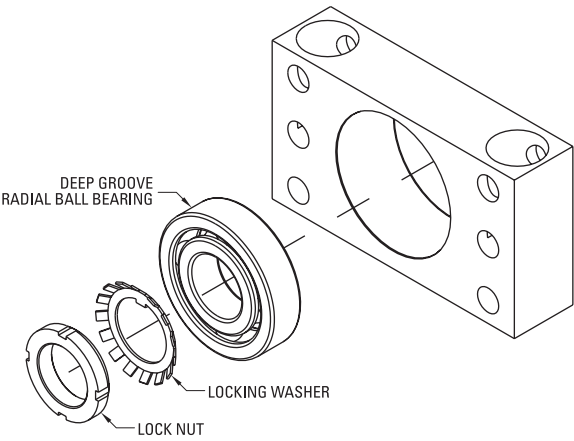

7833292							
7833282							
7833283							
7833284							
7833285							
7833286							
7833287							
7833288							

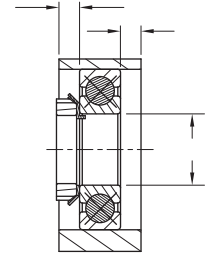
[illegible]

TYPE BF, REQUIRED FOR BF SUPPORT

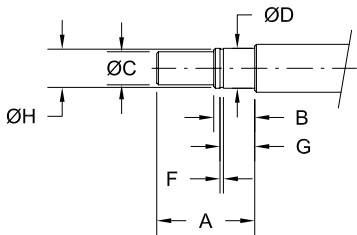

TYPE BK, REQUIRED FOR BK SUPPORT

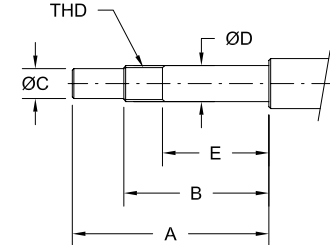

TYPE BF1, REQUIRED FOR BF SUPPORT

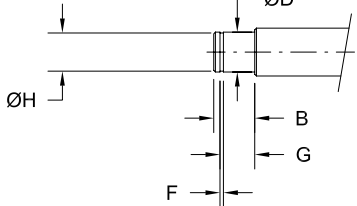

TYPE BK1, REQUIRED FOR BK SUPPORT

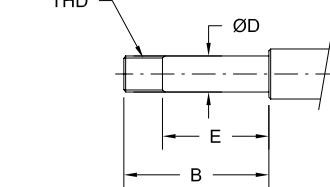

	7833398										7833391						
	7833399										7833392						
	7833400										7833393						
	7833401										7833394						
	7833402										7833395						
	7833403										7833396						
	7833404										7833397						

TYPE FF, REQUIRED FOR FF SUPPORT

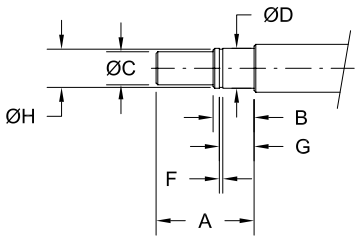

TYPE FK, REQUIRED FOR FK SUPPORT

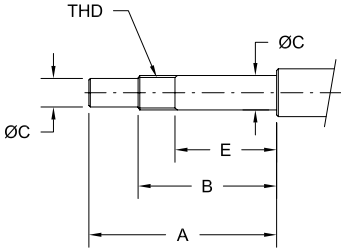

TYPE FF1, REQUIRED FOR FF SUPPORT

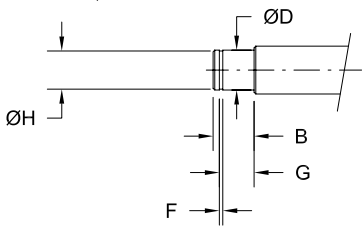

TYPE FK1, REQUIRED FOR FK SUPPORT

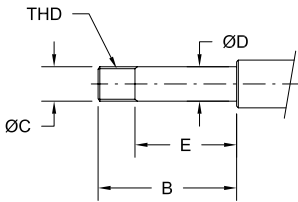

	7833411										7833405							
	7833412										7833406							
	7833413										7833407							
	7833414										7833408							
	7833415										7833409							
	7833416										7833410							

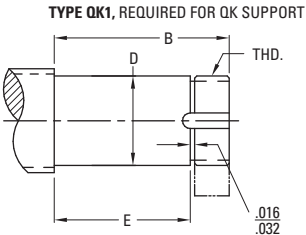
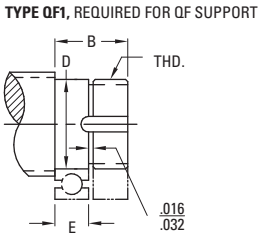
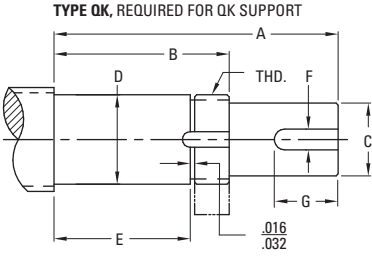
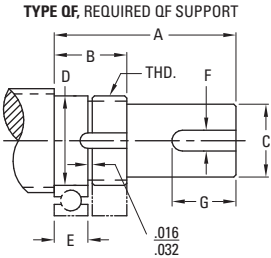

	7829546				7833292							
	7829547				7833282							
	7829548				7833283							
	7829549				7833284							
	7829550				7833285							
	7829551				7833286							
	7829552				7833287							
	7829553				7833288							

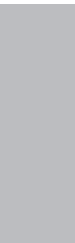

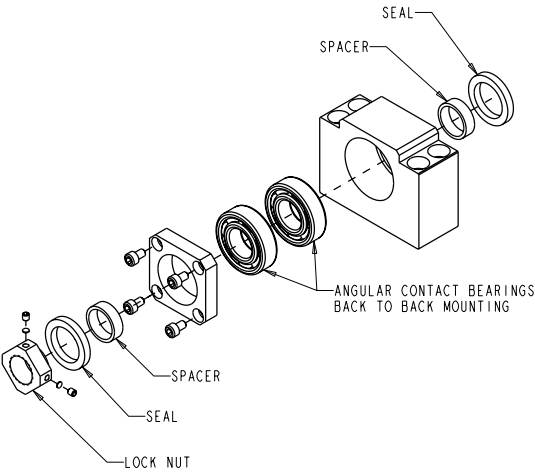

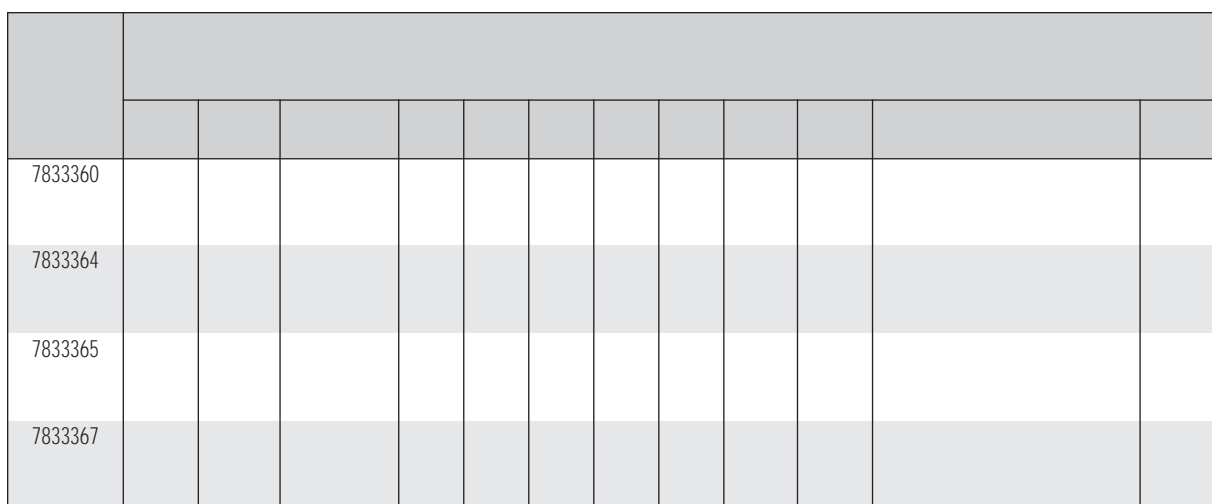

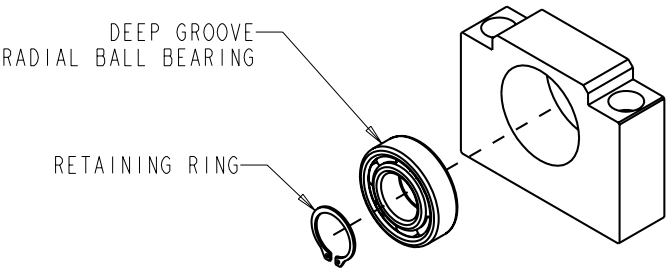

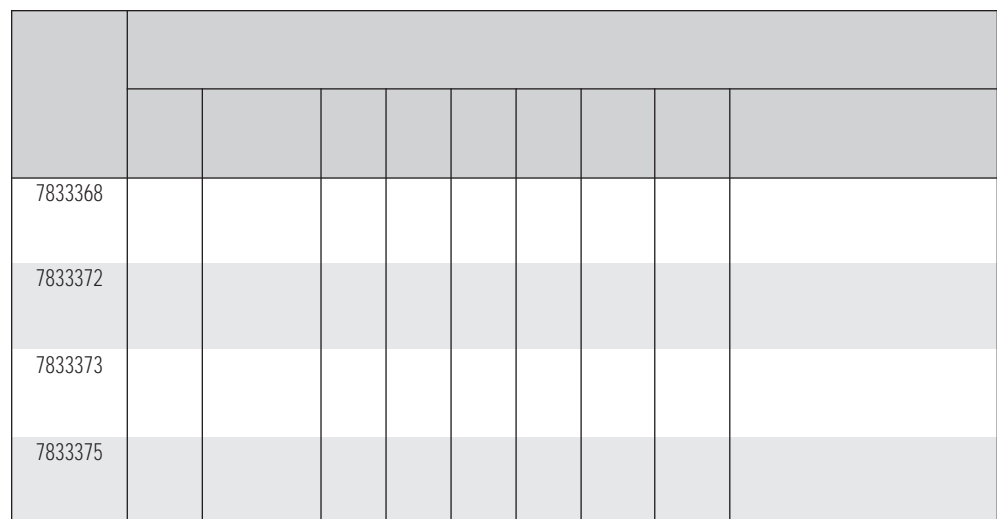

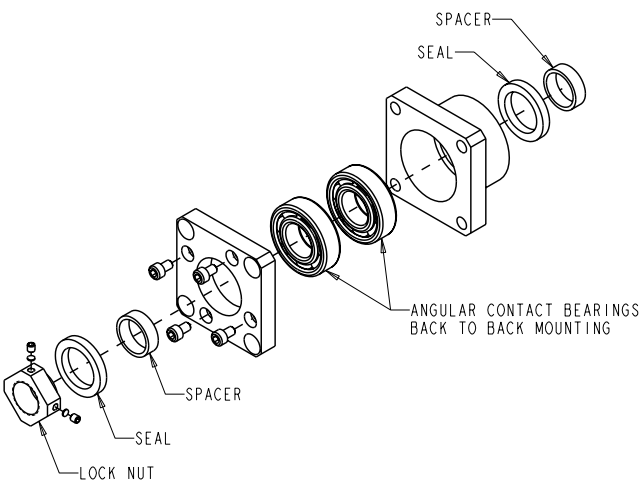

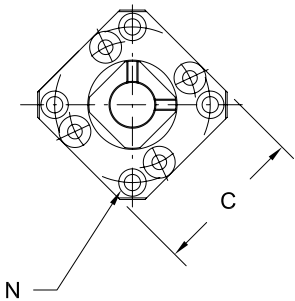

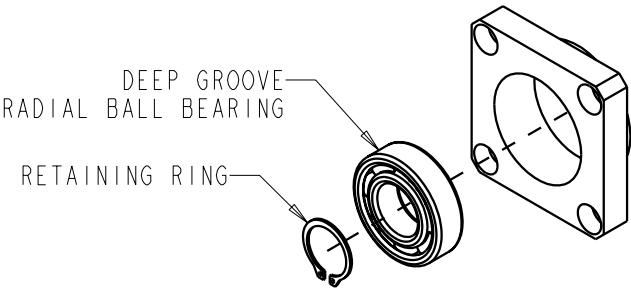

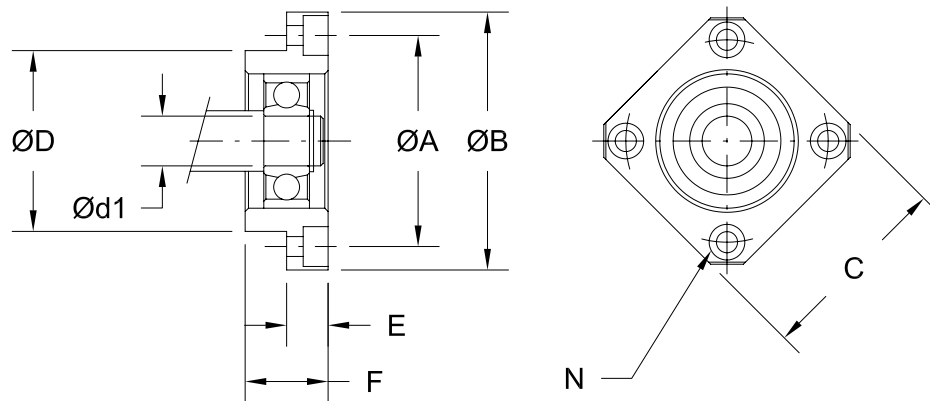

7833368								
7833372								
7833373								

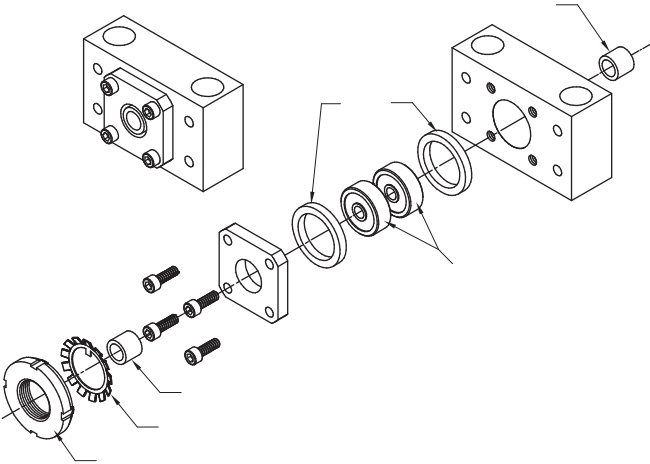

7828282 ⁽¹⁾							
7824157							
7824158							
7829554							
7824161							

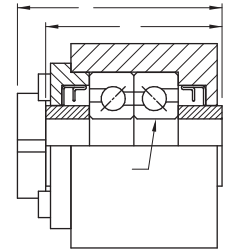
[illegible]

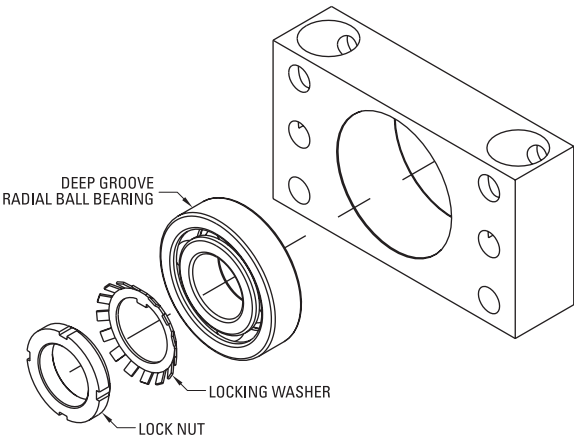

7833291							
7833265							
7833268							
7833273							
7833279							

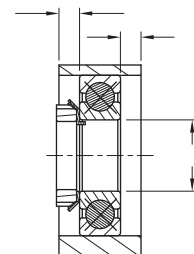
[illegible]

TYPE BK, REQUIRED FOR BK SUPPORT

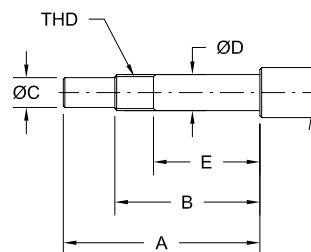

TYPE BK1, REQUIRED FOR BK SUPPORT

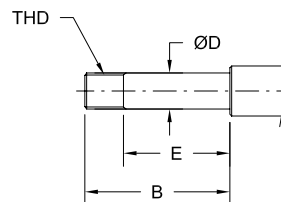
[illegible]

Technical drawing of a shaft with a THD (Threaded Hole Diameter) and dimensions A, B, E, and ØC.

[illegible]

Technical drawing of a cylindrical component. The drawing shows a cylinder with a diameter labeled $\varnothing D$. A section line is shown on the right side. The total length of the cylinder is labeled B . The length of the sectioned part is labeled E . The thickness of the sectioned part is labeled $\varnothing C$. The label THD points to the sectioned part.

[illegible]

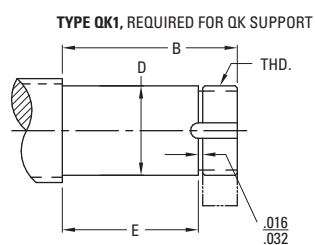
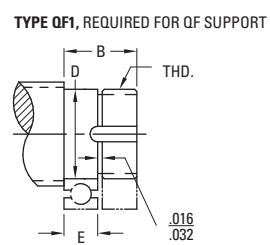
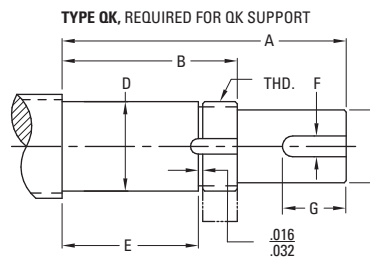
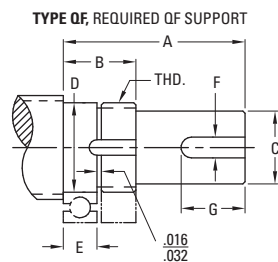
[illegible]



USA, Canada and Mexico

Switzerland

France

United Kingdom

Germany

Asia Pacific

Italy

China

Spain

India

Sweden

Japan