

ACCUMINI 20mm ASSEMBLY

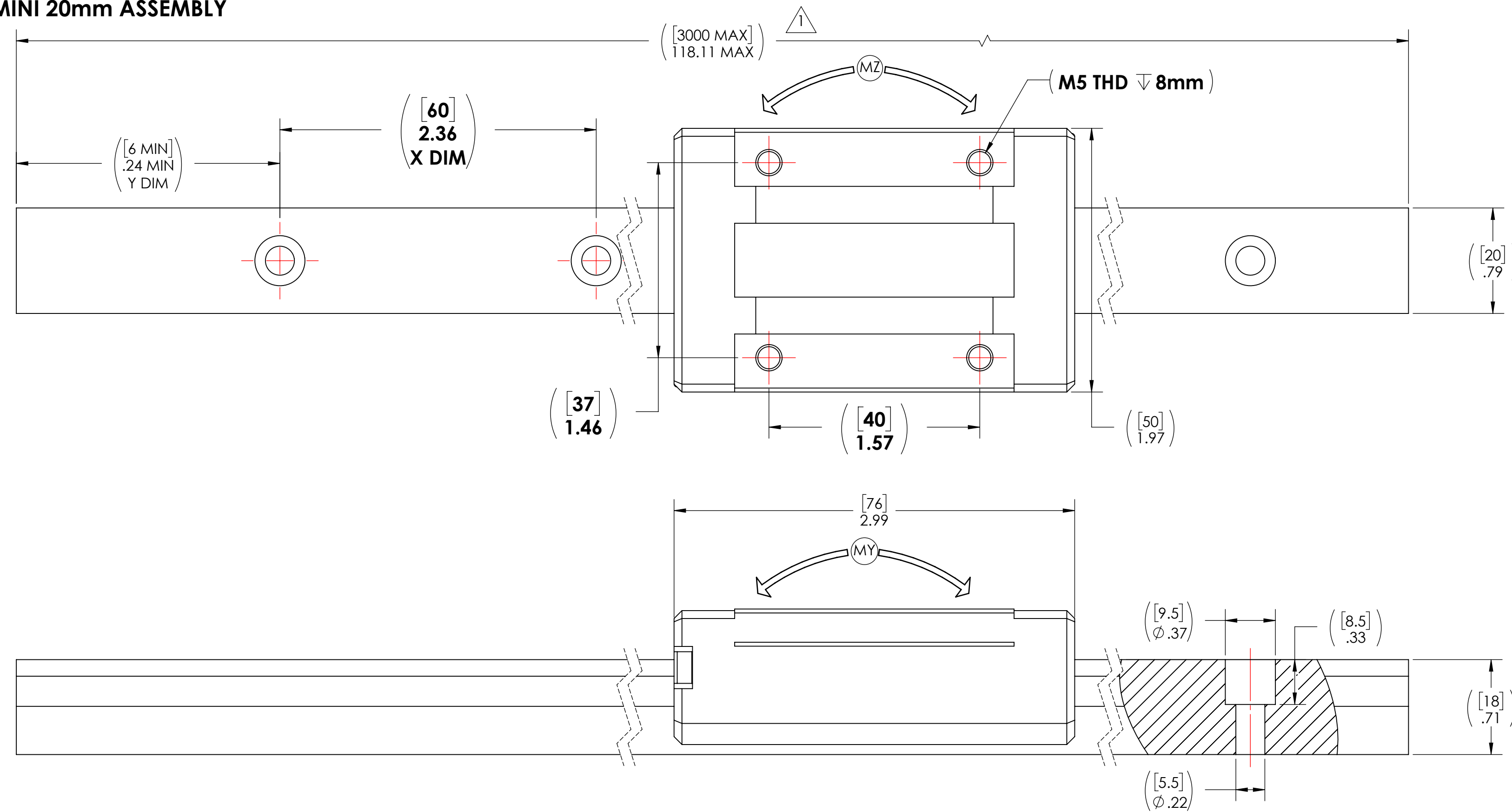

MOMENT RATINGS					
STATIC MOMENT (Nm ²)			DYNAMIC MOMENT (Nm ²)		
MX	MY	MZ	MX	MY	MZ
235	140	140	157.5	94.5	94.5

NOTES:

- MAXIMUM LENGTH FOR 1 PIECE RAIL CONSTRUCTION. BUTT JOINTING IS POSSIBLE FOR LONGER LENGTHS IF REQUIRED.
- CARRIAGE MATERIALS: POLYMER RETAINER, STAINLESS STEEL BALLS.
- CARRIAGES AND RAILS CANNOT BE INTERCHANGED BETWEEN PRODUCT FAMILIES.
- (2) ACCURACY CLASSES TO CHOOSE FROM (HIGH GRADE AND PRECISION GRADE).
- OPERATING PARAMETERS:
 - MAX VELOCITY = 3 m/s
 - MAX ACCELERATION = 50 m/s²
 - MAX TEMPERATURE = 80 °C
- DYNAMIC LOAD RATING = 14,956 N (BASED ON 50km LIFE).**
- STATIC LOAD CAPACITY = 23,000 N.
- SEE CATALOG OR WEBSITE FOR MORE DETAILS.
- DYNAMIC LOAD AND MOMENT RATINGS:
 - C = DYNAMIC LOAD
 - Co = STATIC LOAD
 - MX = YAW MOMENT
 - MY = PITCH MOMENT
 - MZ = ROLL MOMENT

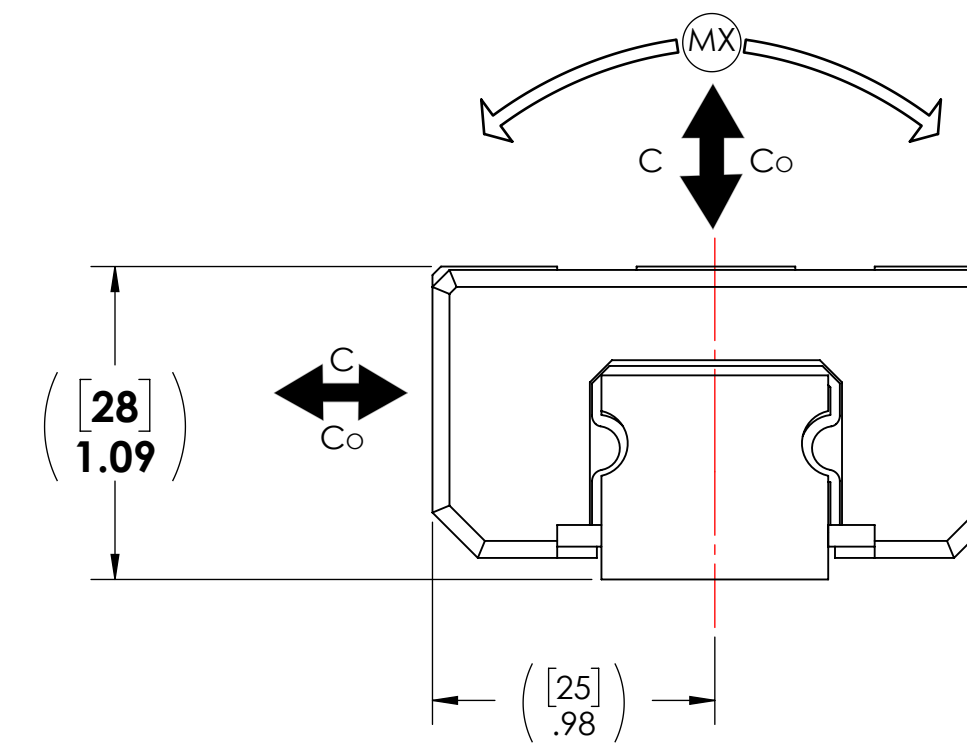

ACCUMINI PART NUMBERS	
ASSEMBLY	xAD20AAxxLxxxx Y=xx
CARRIAGE	CD20AAxx
RAIL	RD20xLxxxx Y=xx

400 SERIES 20mm ASSEMBLY

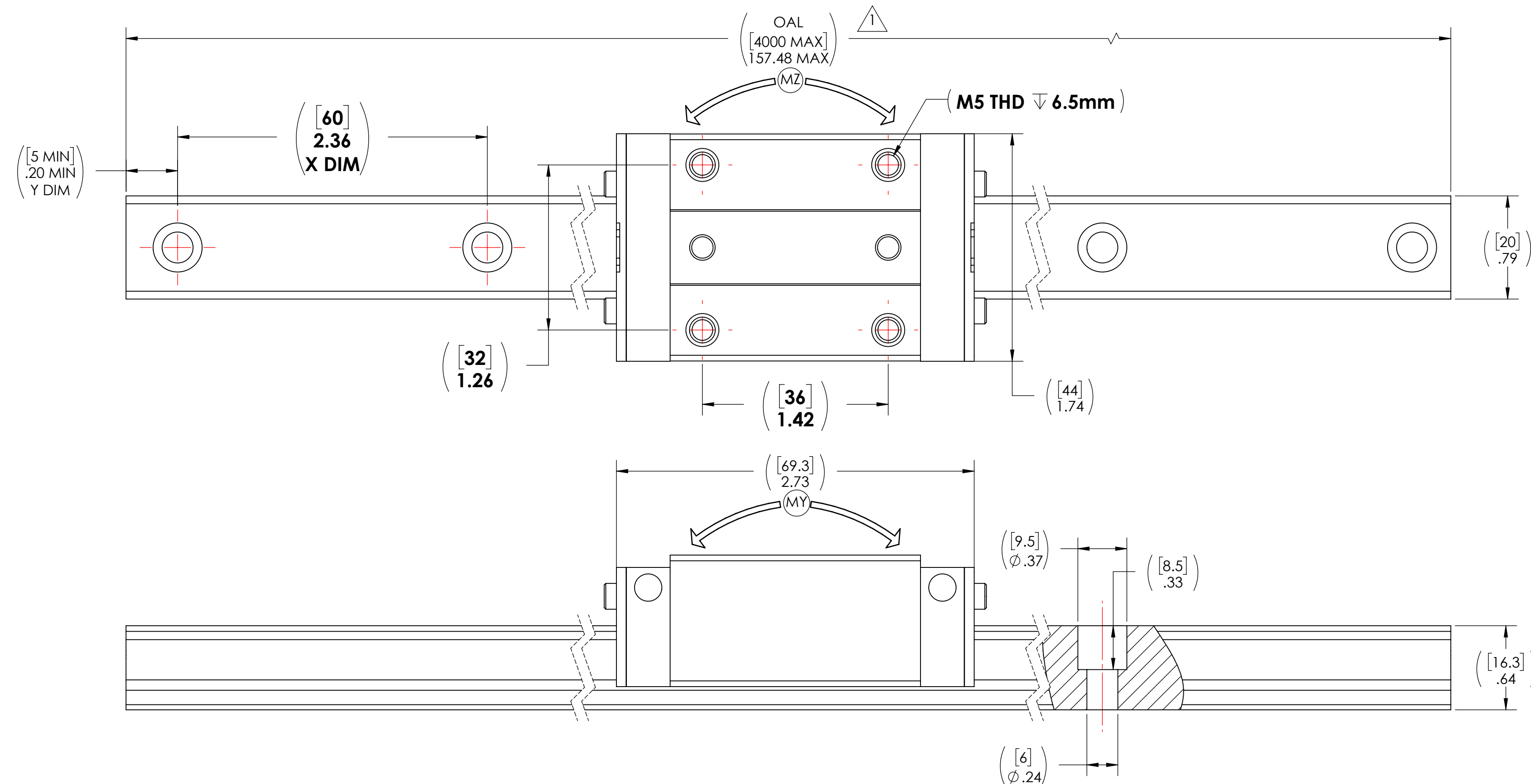

MOMENT RATINGS					
STATIC MOMENT (Nm ²)			DYNAMIC MOMENT (Nm ²)		
MX	MY	MZ	MX	MY	MZ
285	221	221	166	129	129

NOTES:

- MAXIMUM LENGTH FOR 1 PIECE RAIL CONSTRUCTION. BUTT JOINTING IS POSSIBLE FOR LONGER LENGTHS IF REQUIRED.
- CARRIAGE POLYMER RETURN SYSTEM, CARBON STEEL BALLS. AVAILABLE IN (2) INTERNAL CONFIGURATIONS WHICH FIT THE SAME RAIL MATERIAL (421).
 - STANDARD BALL (411)
 - BALL CARRIAGE (413)
- CARRIAGES AND RAILS CANNOT BE INTERCHANGED BETWEEN PRODUCT FAMILIES.
- SEVERAL ACCESSORIES AND MODIFICATIONS TO CARRIAGE AND RAIL ARE AVAILABLE.
- (2) ACCURACY CLASSES TO CHOOSE FROM (HIGH GRADE OR NORMAL GRADE).
- OPERATING PARAMETERS:
 - MAX VELOCITY = 5 m/s
 - MAX ACCELERATION = 50 m/s²
 - TEMPERATURES:
 - MAX 80 °C
 - MIN -40 °C
- DYNAMIC LOAD RATING = 14,300 N (BASED ON 50km LIFE).**
- STATIC LOAD RATING = 30,500 N.
- SEE CATALOG OR WEBSITE FOR MORE DETAILS.
- DYNAMIC AND STATIC MOMENT LOAD RATINGS:
 - C = DYNAMIC LOAD
 - Co = STATIC LOAD
 - MX = YAW MOMENT
 - MY = PITCH MOMENT
 - MZ = ROLL MOMENT

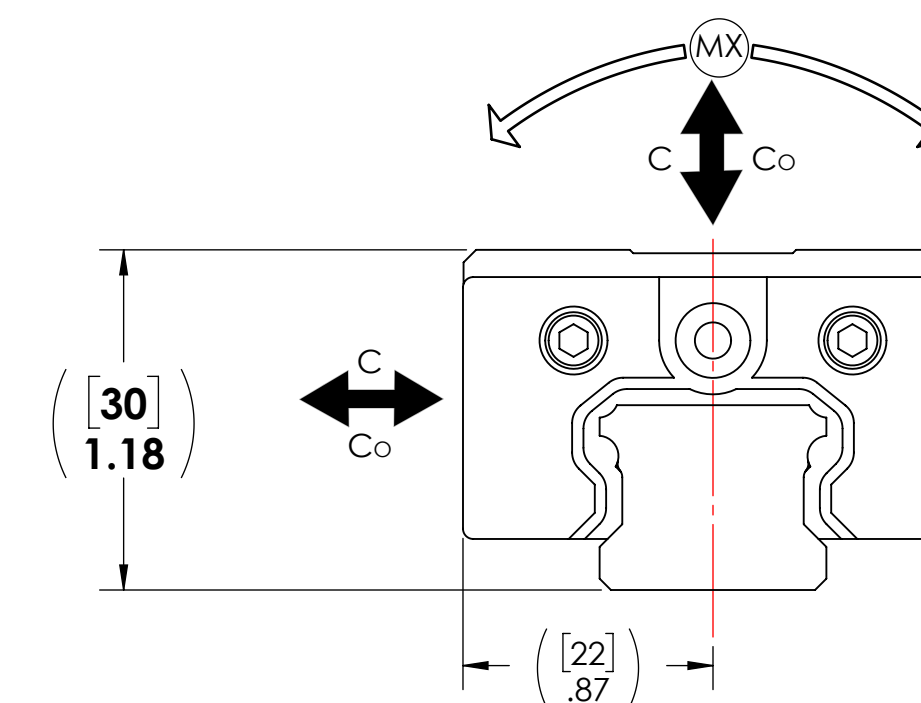

400 SERIES PART NUMBERS	
ASSEMBLY	441x20Cx-xA+xxxx Y=xx
CARRIAGE	411x20Cx
RAIL	421x20A+xxxx Y=xx

ECN	REV.	DESCRIPTION	BY	DATE
REVISIONS				

CUSTOMER NO.	
FINISH	
HEAT TREAT	ERROR!Heat Treat
MATERIAL	

THIS DOCUMENT IS THE PROPERTY OF THOMSON LINEAR. IT IS FURNISHED TO YOU FOR CONFIDENTIAL INFORMATION PURPOSES ONLY AND IS NOT TO BE DISCLOSED, REPRODUCED OR USED FOR MANUFACTURING PURPOSES WITHOUT THE EXPRESS WRITTEN PERMISSION OF THOMSON LINEAR.

UNLESS OTHERWISE SPECIFIED: MACHINE SURFACES: 125-μ" BUBBLER HOLES AND SHARP EDGES: 0.050" THIS DO NOT SCALE DRAWINGS SYMBOLS PER ANSI Y14.5

REFERENCES:	400 SERIES CROSSOVER (RECOMMENDED)
PRODUCT RELEASE NO.	
DRAWN BY	JDB
DATE	8/3/2023
SCALE	1.5:1
PAGE	1 of 1
SIZE	D

1300 N. STATE ST. MARENGO, IL 60152	
TITLE COMPARISON DRAWING	
DRAWING NO. ACCUMINI SIZE 20 COMPARISON	REV -