

**ACCUMINI 15mm ASSEMBLY**

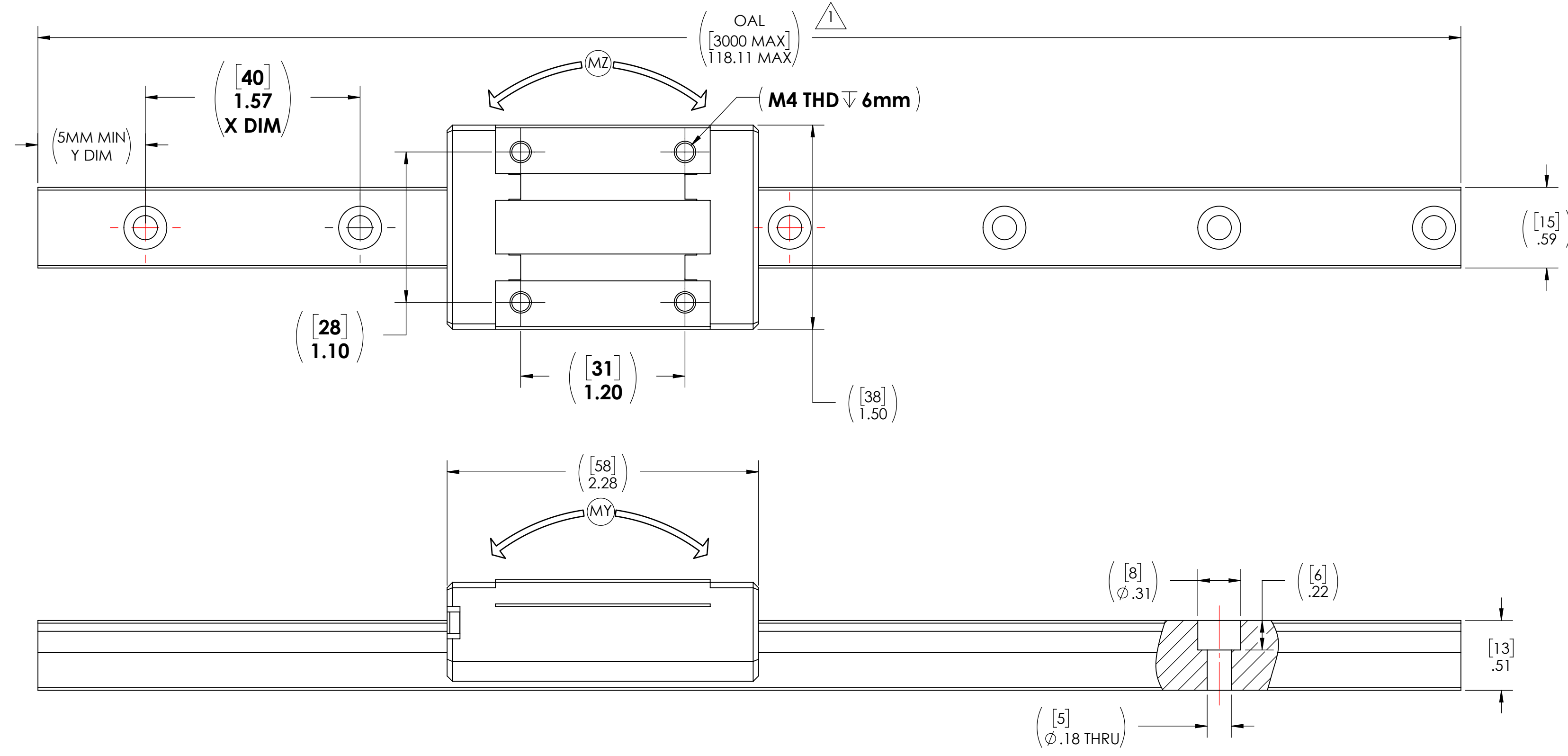

MOMENT RATINGS					
STATIC MOMENT (Nm <sup>2</sup> )			DYNAMIC MOMENT (Nm <sup>2</sup> )		
MX	MY	MZ	MX	MY	MZ
96	66	66	64	44	44

NOTES:

- MAXIMUM LENGTH FOR 1 PIECE RAIL CONSTRUCTION. BUTT JOINTING IS POSSIBLE FOR LONGER LENGTHS IF REQUIRED.
- CARRIAGE MATERIALS: POLYMER RETAINER, STAINLESS STEEL BALLS.
- CARRIAGES AND RAILS CANNOT BE INTERCHANGED BETWEEN PRODUCT FAMILIES.
- (2) ACCURACY CLASSES TO CHOOSE FROM (HIGH GRADE AND PRECISION GRADE).
- OPERATING PARAMETERS:
  - MAX VELOCITY = 3 m/s
  - MAX ACCELERATION = 50 m/s<sup>2</sup>
  - MAX TEMPERATURE = 80 °C
- DYNAMIC LOAD RATING = 8032 N (BASED ON 50km LIFE).**
- STATIC LOAD CAPACITY = 15200 N.
- SEE CATALOG OR WEBSITE FOR MORE DETAILS.
- DYNAMIC LOAD AND MOMENT RATINGS:
  - C = DYNAMIC LOAD
  - C<sub>0</sub> = STATIC LOAD
  - MX = YAW MOMENT
  - MY = PITCH MOMENT
  - MZ = ROLL MOMENT

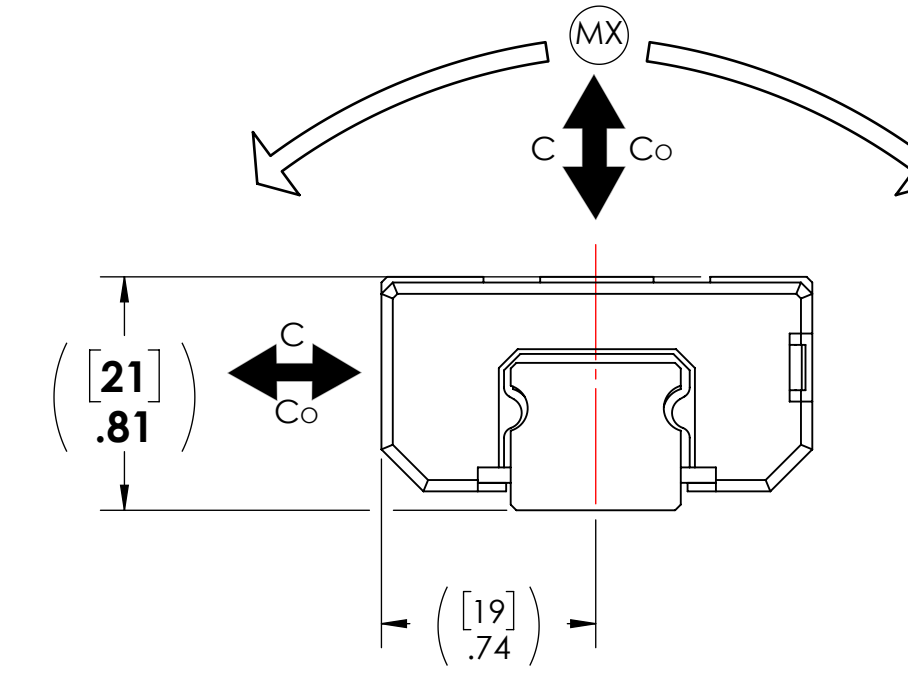

ACCUMINI PART NUMBERS	
ASSEMBLY	xAD15AAxxLxxxx Y=xx
CARRIAGE	CD15AAxx
RAIL	RD15xLxxxx Y=xx

**400 SERIES 15mm ASSEMBLY**

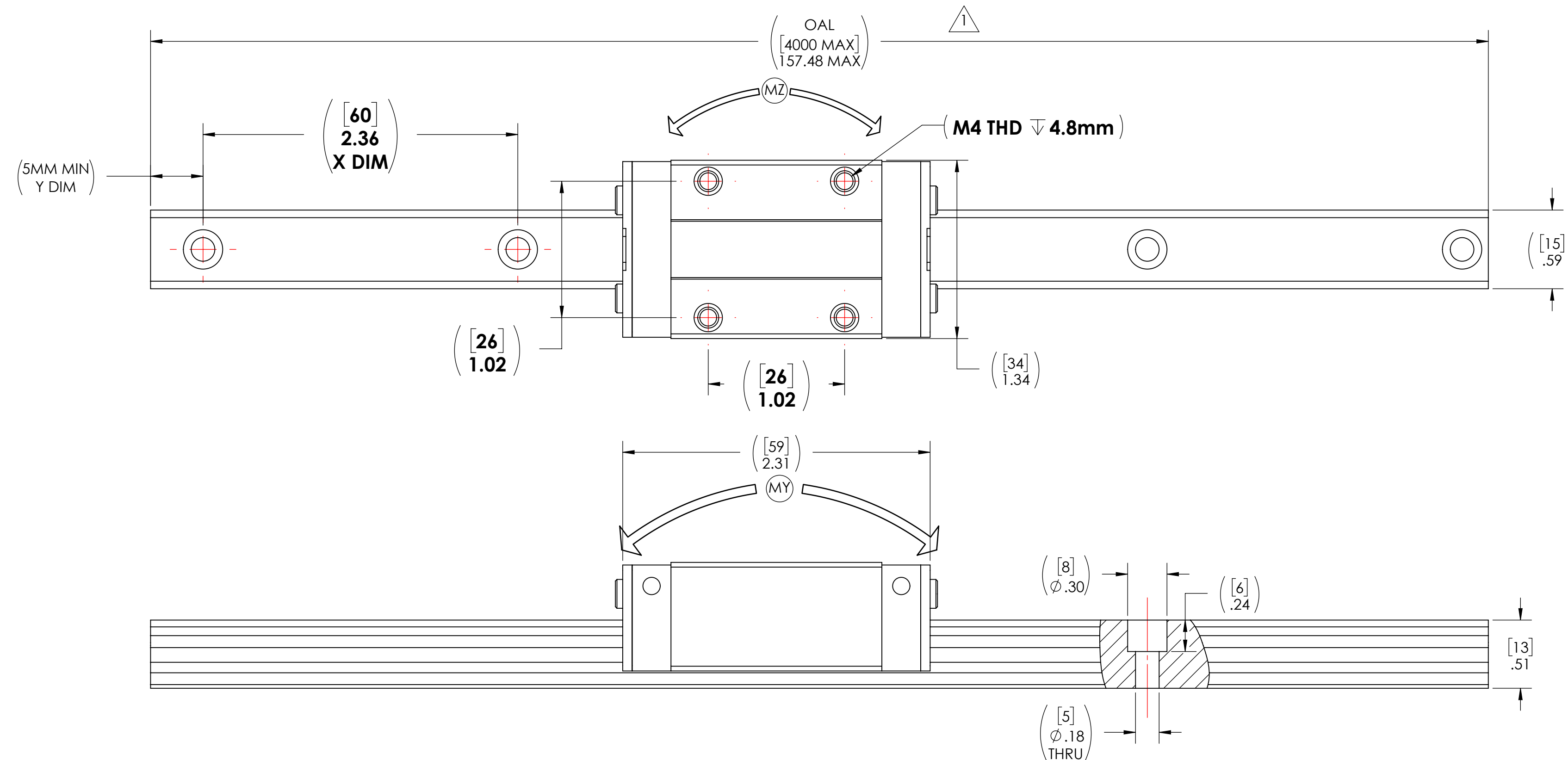

MOMENT RATINGS					
STATIC MOMENT (Nm <sup>2</sup> )			DYNAMIC MOMENT (Nm <sup>2</sup> )		
MX	MY	MZ	MX	MY	MZ
135	118	118	65	56	56

NOTES:

- MAXIMUM LENGTH FOR 1 PIECE RAIL CONSTRUCTION. BUTT JOINTING IS POSSIBLE FOR LONGER LENGTHS IF REQUIRED.
- CARRIAGE POLYMER RETURN SYSTEM, CARBON STEEL BALLS. AVAILABLE IN (2) INTERNAL CONFIGURATIONS WHICH FIT THE SAME RAIL MATERIAL (421).
  - STANDARD BALL (411)
  - BALL CARRIAGE (413)
- CARRIAGES AND RAILS CANNOT BE INTERCHANGED BETWEEN PRODUCT FAMILIES.
- SEVERAL ACCESSORIES AND MODIFICATIONS TO CARRIAGE AND RAIL ARE AVAILABLE.
- (2) ACCURACY CLASSES TO CHOOSE FROM (HIGH GRADE OR NORMAL GRADE).
- OPERATING PARAMETERS:
  - MAX VELOCITY = 5 m/s
  - MAX ACCELERATION = 50 m/s<sup>2</sup>
  - TEMPERATURES:
    - MAX 80 °C
    - MIN -40 °C
- DYNAMIC LOAD RATING = 9,300 N (BASED ON 50km LIFE).**
- STATIC LOAD RATING = 19600 N.
- SEE CATALOG OR WEBSITE FOR MORE DETAILS.
- DYNAMIC AND STATIC MOMENT LOAD RATINGS:
  - C = DYNAMIC LOAD
  - C<sub>0</sub> = STATIC LOAD
  - MX = YAW MOMENT
  - MY = PITCH MOMENT
  - MZ = ROLL MOMENT

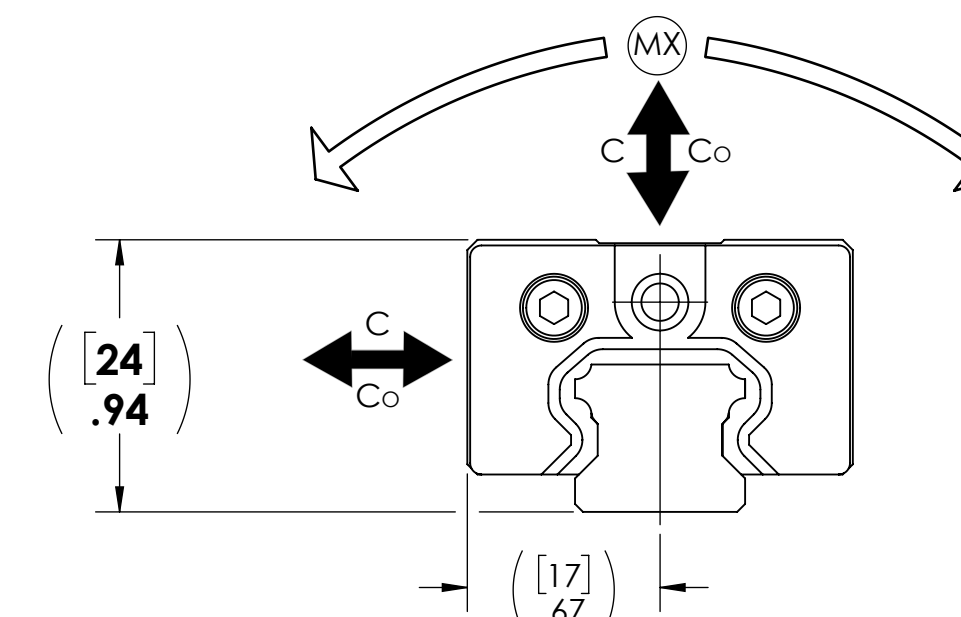

400 SERIES PART NUMBERS	
ASSEMBLY	441x15Cx-xA+xxxx Y=xx
CARRIAGE	411x15Cx
RAIL	421x15A+xxxx Y=xx

ECN	REV.	DESCRIPTION	BY	DATE
REVISIONS				

CUSTOMER NO.	
FINISH	UNLESS OTHERWISE SPECIFIED: MACHINE SURFACES: 125- $\mu$ DEBURR HOLES AND SHARP EDGES: 0.050/0.1015 DO NOT SCALE DRAWINGS SYMBOLS PER ANSI Y14.5
HEAT TREAT	
MATERIAL	

THIS DOCUMENT IS THE PROPERTY OF THOMSON LINEAR. IT IS FURNISHED TO YOU FOR CONFIDENTIAL INFORMATION PURPOSES ONLY AND IS NOT TO BE DISCLOSED, REPRODUCED OR USED FOR MANUFACTURING PURPOSES WITHOUT THE EXPRESS WRITTEN PERMISSION OF THOMSON LINEAR.

UNLESS OTHERWISE SPECIFIED: MACHINE SURFACES: 125- $\mu$  DEBURR HOLES AND SHARP EDGES: 0.050/0.1015 DO NOT SCALE DRAWINGS SYMBOLS PER ANSI Y14.5

THIRD ANGLE OF PROJECTION

REFERENCES:	400 SERIES CROSSOVER (RECOMMENDED)
PRODUCT RELEASE NO.	
DRAWN BY:	JDB
DATE:	8/3/2023
SCALE:	1.5:1
PAGE:	1 of 1
SIZE:	D

<b>THOMSON</b> 1300 N. STATE ST. MARENGO, IL 60152	
TITLE: COMPARISON DRAWING	
DRAWING NO. ACCUMINI SIZE 15 COMPARISON	REV -

**ACCUMINI 15mm ASSEMBLY**

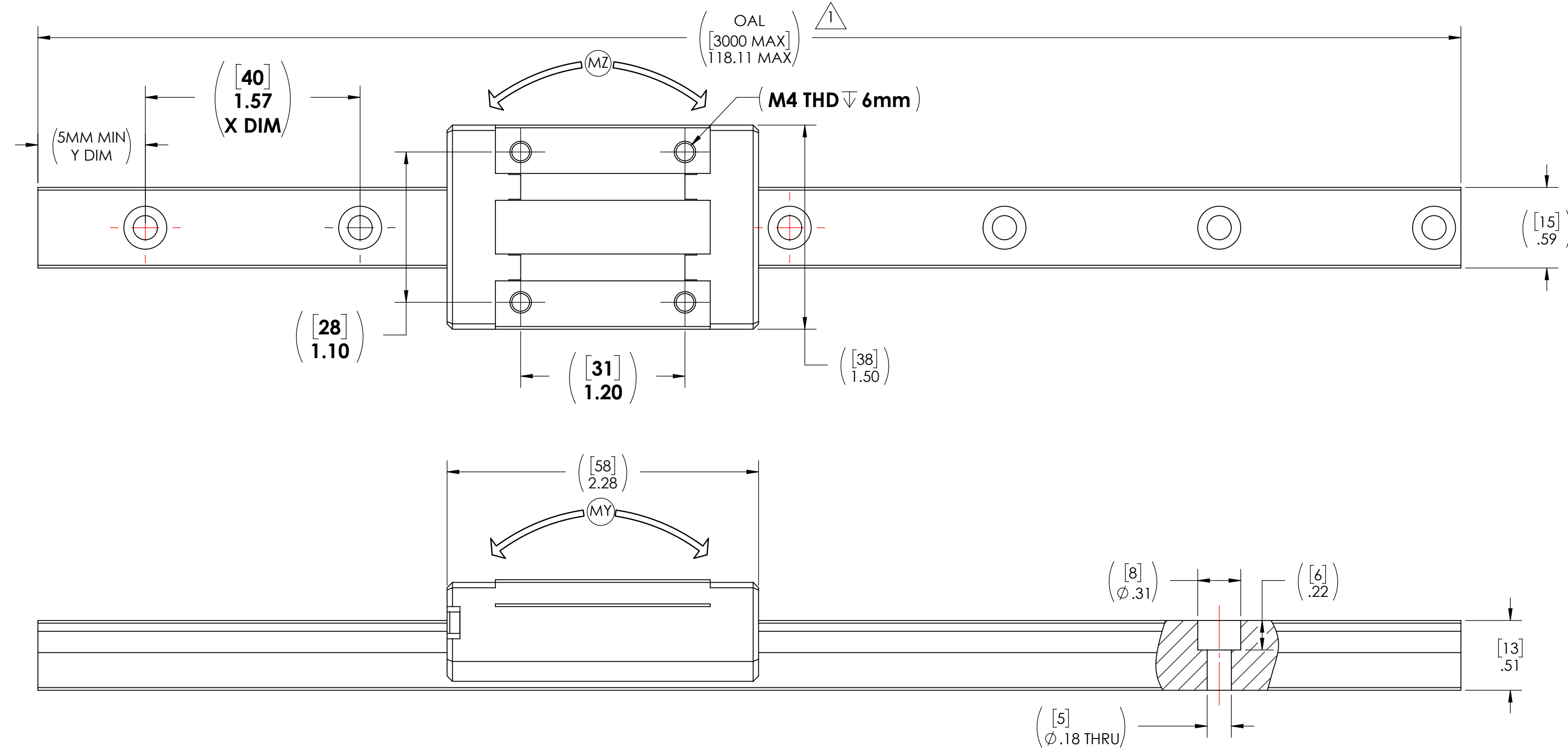

MOMENT RATINGS					
STATIC MOMENT (Nm <sup>2</sup> )			DYNAMIC MOMENT (Nm <sup>2</sup> )		
MX	MY	MZ	MX	MY	MZ
96	66	66	64	44	44

- NOTES:
- MAXIMUM LENGTH FOR 1 PIECE RAIL CONSTRUCTION, BUTT JOINTING IS POSSIBLE FOR LONGER LENGTHS IF REQUIRED.
  - CARRIAGE MATERIALS: POLYMER RETAINER, STAINLESS STEEL BALLS.
  - CARRIAGES AND RAILS CANNOT BE INTERCHANGED BETWEEN PRODUCT FAMILIES.
  - [2] ACCURACY CLASSES TO CHOOSE FROM (HIGH GRADE AND PRECISION GRADE).
  - OPERATING PARAMETERS:
    - MAX VELOCITY = 3 m/s
    - MAX ACCELERATION = 50 m/s<sup>2</sup>
    - MAX TEMPERATURE = 80 °C
  - DYNAMIC LOAD RATING = 8032 N (BASED ON 50km LIFE).**
  - STATIC LOAD CAPACITY = 15200 N.
  - SEE CATALOG OR WEBSITE FOR MORE DETAILS.
  - DYNAMIC AND STATIC LOAD AND MOMENT RATINGS:
    - C = DYNAMIC LOAD
    - C<sub>0</sub> = STATIC LOAD
    - MX = YAW MOMENT
    - MY = PITCH MOMENT
    - MZ = ROLL MOMENT

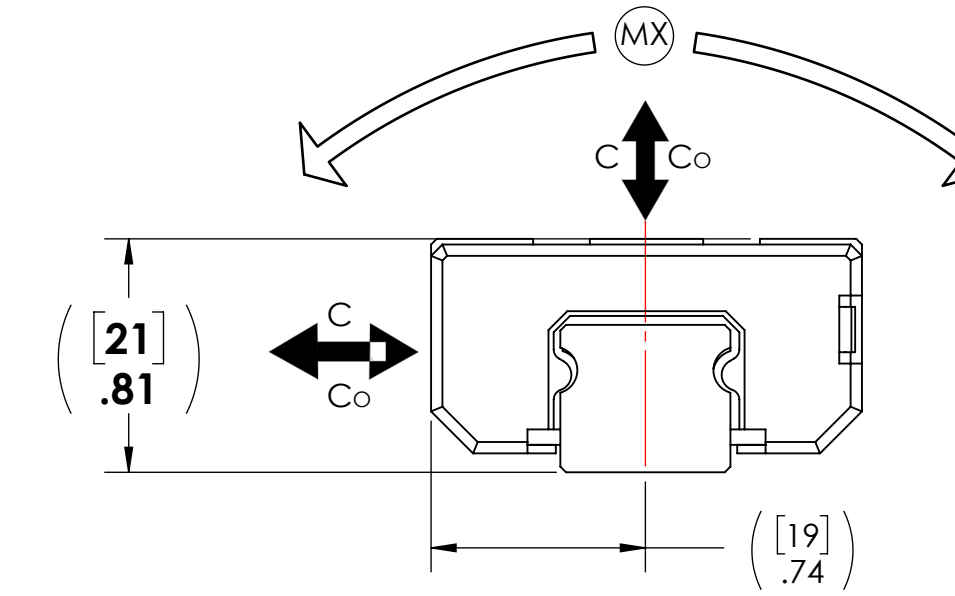

ACCUMINI PART NUMBERS	
ASSEMBLY	xAD15AAxxLxxxx Y=xx
CARRIAGE	CD15AAxx
RAIL	RD15xLxxxx Y=xx

**MICROGUIDE 15mm ASSEMBLY**

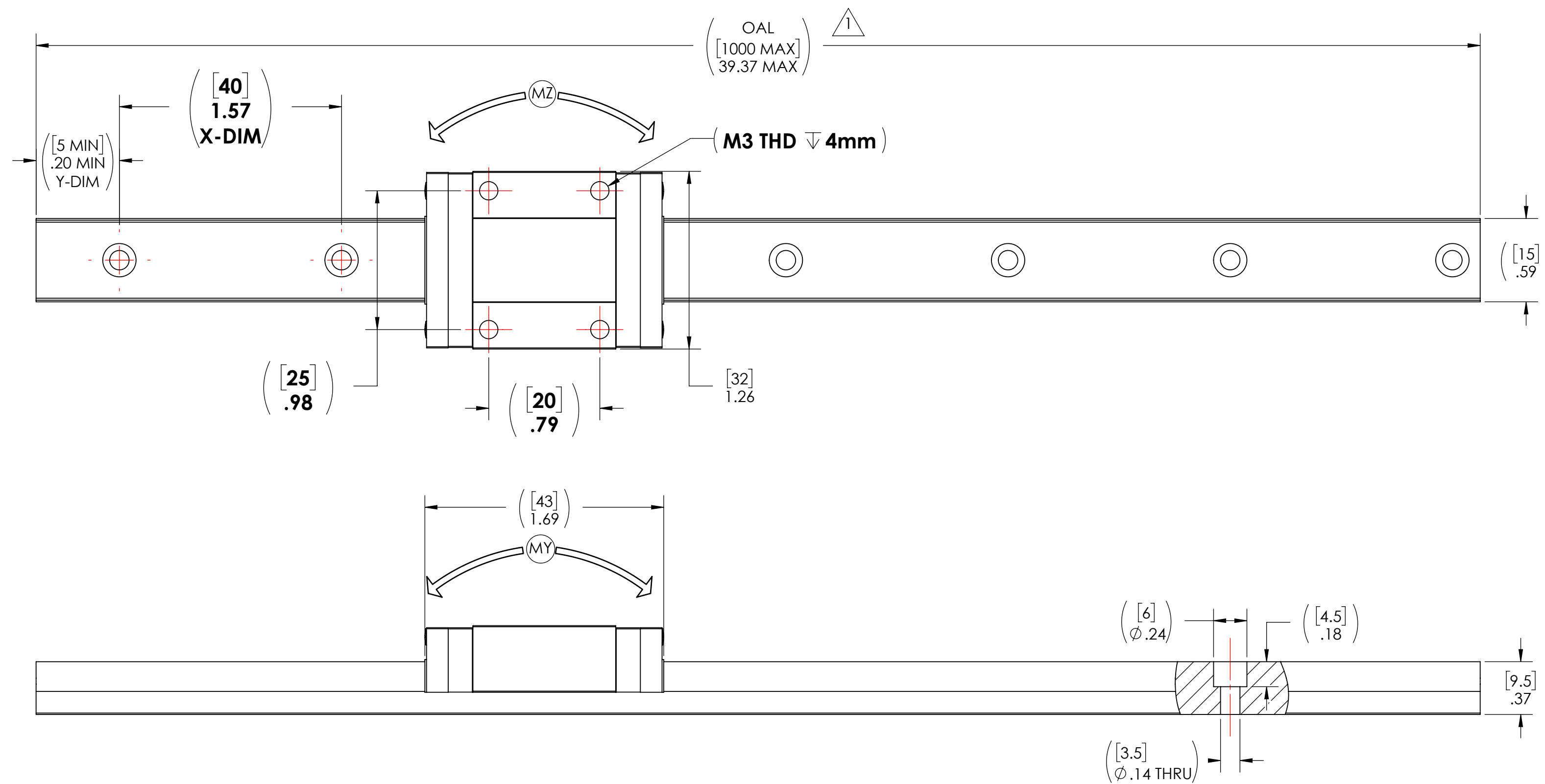

MOMENT RATINGS					
STATIC MOMENT (Nm <sup>2</sup> )			DYNAMIC MOMENT (Nm <sup>2</sup> )		
MX	MY	MZ	MX	MY	MZ
30.2	16.5	17.9	NOT RATED		

- NOTES:
- MAXIMUM LENGTH FOR 1 PIECE RAIL CONSTRUCTION, BUTT JOINTING IS POSSIBLE FOR LONGER LENGTHS IF REQUIRED.
  - CARRIAGES AND RAILS CANNOT BE INTERCHANGED BETWEEN PRODUCT FAMILIES.
  - [3] ACCURACY CLASSES TO CHOOSE FROM (NORMAL GRADE, HIGH GRADE, OR PRECISION GRADE).
  - OPERATING PARAMETERS:
    - MAX VELOCITY = 3 m/s
    - MAX ACCELERATION = 50 m/s<sup>2</sup>
  - DYNAMIC LOAD RATING = 4,410 N (BASED ON 50km LIFE).**
  - STATIC LOAD RATING = 6570 N.
  - SEE CATALOG OR WEBSITE FOR MORE DETAILS.
  - DYNAMIC AND STATIC LOAD AND MOMENT RATINGS:
    - C = DYNAMIC LOAD
    - C<sub>0</sub> = STATIC LOAD
    - MX = YAW MOMENT
    - MY = PITCH MOMENT
    - MZ = ROLL MOMENT

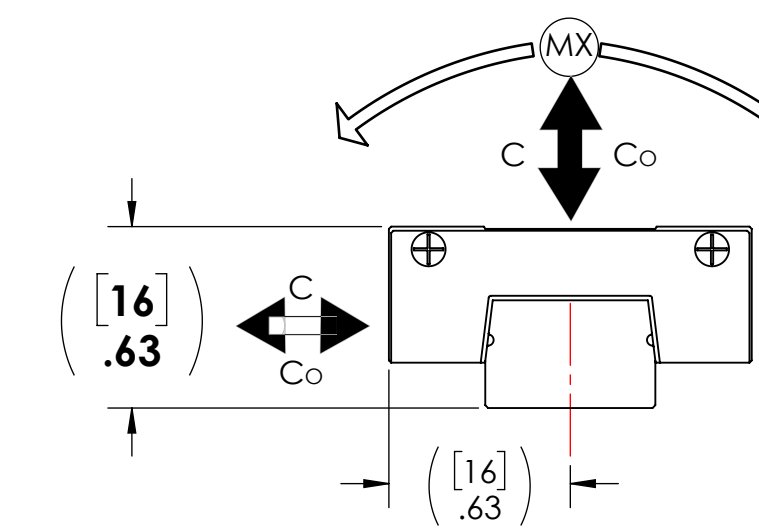

MICROGUIDE PART NUMBERS	
ASSEMBLY	xTSR15ZMUUxx+xxxx Y=xx
*PRODUCT SOLD AS ASSEMBLY ONLY	

ECN	REV.	DESCRIPTION	BY	DATE
REVISIONS				

CUSTOMER NO.	
FINISH	
HEAT TREAT	
MATERIAL	

THIS DOCUMENT IS THE PROPERTY OF THOMSON LINEAR. IT IS FURNISHED TO YOU FOR CONFIDENTIAL INFORMATION PURPOSES ONLY AND IS NOT TO BE DISCLOSED, REPRODUCED OR USED FOR MANUFACTURING PURPOSES WITHOUT THE EXPRESS WRITTEN PERMISSION OF THOMSON LINEAR.

UNLESS OTHERWISE SPECIFIED: MACHINE SURFACES: .125- $\sqrt{R}$  DEBURR HOLES AND SHARP EDGES TO .0050 IN THIS DO NOT SCALE DRAWINGS SYMBOLS PER ANSI Y14.5

REFERENCES: MICROGUIDE CROSSOVER SAME X-DIMENSION

PRODUCT RELEASE NO.	DATE	SCALE	SHEET
JDB	8/3/2023	1.5:1	D
APPROVED BY	DATE	PAGE	
		1 of 1	

**THOMSON** 1300 N. STATE ST. MARENGO, IL 60152

TITLE	COMPARISON DRAWING
DRAWING NO.	ACCUMINI SIZE 15 COMPARISON
REV	-