

# 3.000 x 0.660 Ball Screw & Ball Nut (R-3066)

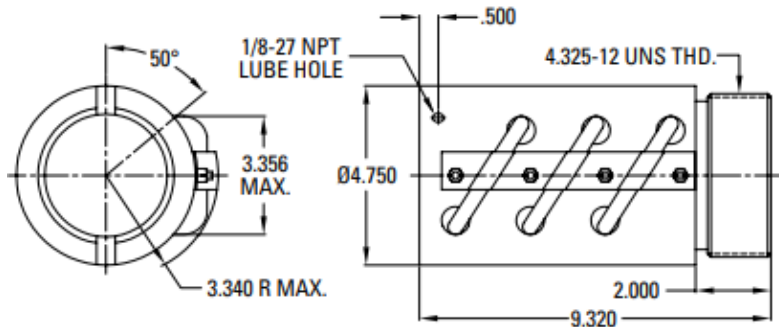

## Thomson Standard Parts

- **Nut: 8130-448-007**
  - Safety Feature: Load Lock Spring
  - Includes Lube Port
  - Wiper Kit included
  - Not recommended to use with Nook Screw



- **Screw: 190-9117/190-9140**
  - Screw Material: 1050 Steel
  - Standard Finish: Polished & Oiled



## Recommended Nook Replacement

- **Nut: SBN10202**
  - Safety Feature: Safety Thread & Solid Deflectors (shown in Blue)
  - Optional Lube Port available upon request
  - Wiper Kit optional
  - Not recommended to use with Thomson Screw

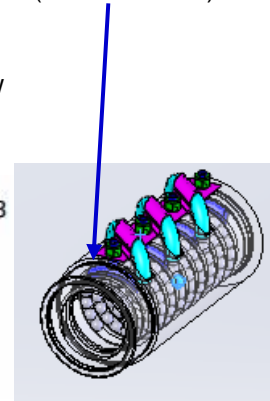
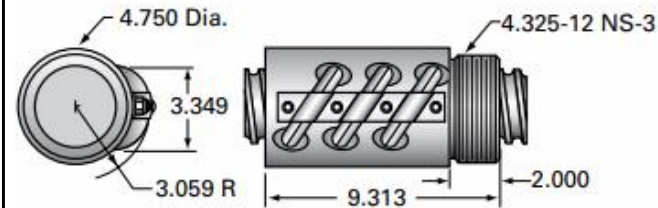

- **Screw: 3000-0660 SRT**
  - Screw Material: 4150 Steel
  - Standard Finish: Black Oxide



## Key Differences:

- Screw Material: 4150 Steel is a higher grade steel which provides higher wear resistance and strength
- Screw Finish: Black Oxide coating – Matte Black finish that provides more lubricity and rust protection during storage

### Nut Assembly:

FORM/FIT/FUNCTION:	NOOK	THOMSON
OD	4.750 +/- .001	4.750 +/- .001
OAL	9.313 +/- .010	9.320 +/- .005
V-THREAD LENGTH	2.000 +/- .010	2.000 +/- .005
DYNAMIC LOAD (lbs)	44,316	44,316
SCREW ROOT Ø	2.480	2.483