

# 2.500 x 0.250 Ball Screw & Ball Nut (R-2504)

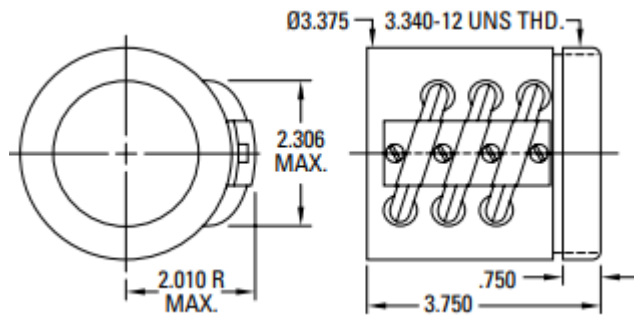

## Thomson Standard Parts

- **Nut: 8125-448-021**
  - Wiper Kit included
  - Compatible with Nook Screw



- **Screw: 190-9560/190-9561**
  - Screw Material: 1050 Steel
  - Standard Finish: Polished & Oiled



## Recommended Nook Replacement

- **Nut: SBN3243**
  - Wiper Kit optional
  - Compatible with Thomson Screw

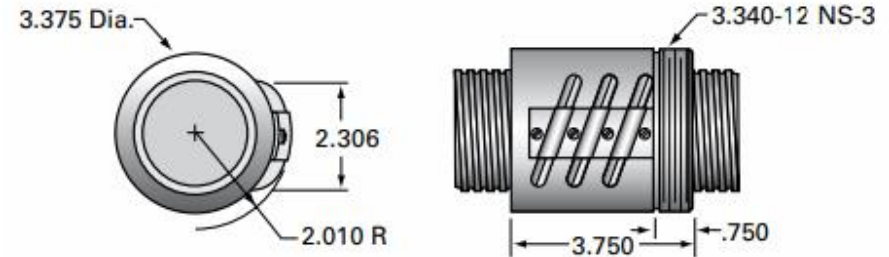

- **Screw: 2500-0250 SRT**
  - Screw Material: 4150 Steel
  - Standard Finish: Black Oxide



## Key Differences:

- Screw Material: 4150 Steel is a higher grade steel which provides higher wear resistance and strength
- Screw Finish: Black Oxide coating – Matte Black finish that provides more lubricity and rust protection during storage

- Nut Assembly:

| FORM/FIT/FUNCTION: | NOOK           | THOMSON        |
|--------------------|----------------|----------------|
| OD                 | 3.375 +/- .005 | 3.375 +/- .001 |
| OAL                | 3.750 +/- .010 | 3.750 +/- .005 |
| V-THREAD LENGTH    | .750 +/- .010  | .750 +/- .005  |
| DYNAMIC LOAD (lbs) | 6,135          | 6,315          |
| SCREW ROOT Ø       | 2.320          | 2.320          |