

2.250 x 1.000 Ball Screw & Ball Nut (R-2201)

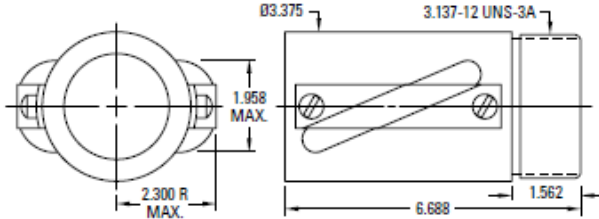

Thomson Standard Parts

- **Nut: 8122-448-006**
 - Safety Feature: None
 - Wiper Kit included
 - Not recommended to use with Nook Screw



- **Screw: 190-9558/190-9559**
 - Screw Material: 1050 Steel
 - Standard Finish: Polished & Oiled



Recommended Nook Replacement

- **Nut: SBN4555**
 - Safety Feature: None
 - Wiper Kit optional
 - Not recommended to use with Thomson Screw

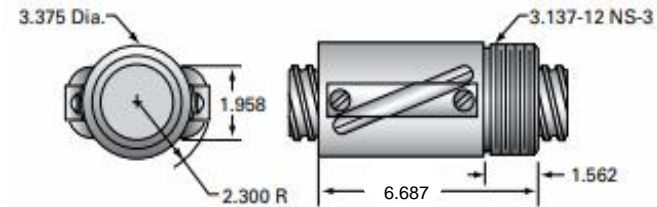

- **Screw: 2250-1000 SRT**
 - Screw Material: 4150 Steel
 - Standard Finish: Black Oxide



Key Differences:

- Screw Material: 4150 Steel is a higher grade steel which provides higher wear resistance and strength
- Screw Finish: Black Oxide coating – Matte Black finish that provides more lubricity and rust protection during storage

Nut Assembly:

FORM/FIT/FUNCTION:	NOOK	THOMSON
OD	3.375 +/- .003	3.375 +/- .001
OAL	6.687 +/- .010	6.688 +/- .005
V-THREAD LENGTH	1.562 +/- .010	1.562 +/- .005
DYNAMIC LOAD (lbs)	26,538	26,538
SCREW ROOT Ø	1.850	1.850